



## 15 Commissioners Court, New Stairs, Chatham, Kent, ME4 4HQ

OPEN DAY WEDNESDAY 15TH DECEMBER CALL TO BOOK YOUR SLOT. Awaiting photos, floor-plan and virtual tour. Simply delightful. Located in a gated development on the outskirts of Chatham Dockyard, with a private drive is this 2 double bedroom terrace house, each bedroom with their own en-suite. This property is the perfect home for first time buyers or home movers alike. Upon entering through the hallway you have the modern fitted kitchen which was installed approximately 5 years ago, a convenient downstairs cloakroom/wc and a spacious lounge/diner with French doors opening to the rear garden. Upstairs there are 2 double bedrooms, one offering an en-suite shower room and the other an en-suite bathroom. The easy to maintain rear garden is nice and flat and backs onto the Ropery buildings in the Dockyard. Gas central heating and double glazed windows are installed and the property benefits from a private drive to the front for one car. The communal road and gate are serviced by a management company and charges are to be verified by your legal representative. This property is located in an area with great transport links with the Medway Tunnel, A2/M2 and mainline train station all nearby. Chatham Dockyard is within walking distance and Dockside shopping centre also close by with a variety of shops, bars and restaurants. Council Tax Band C

- GATED DEVELOPMENT
- MODERN FITTED KITCHEN
- EASY TO MAINTAIN GARDEN
- DRIVE TO FRONT FOR 1 CAR
- GREAT LOCATION FOR TRANSPORT LINKS
- HANDY DOWNSTAIRS WC
- 2 DOUBLE BEDROOMS
- EN-SUITE BATHROOM
- EN-SUITE SHOWER ROOM

**£260,000**

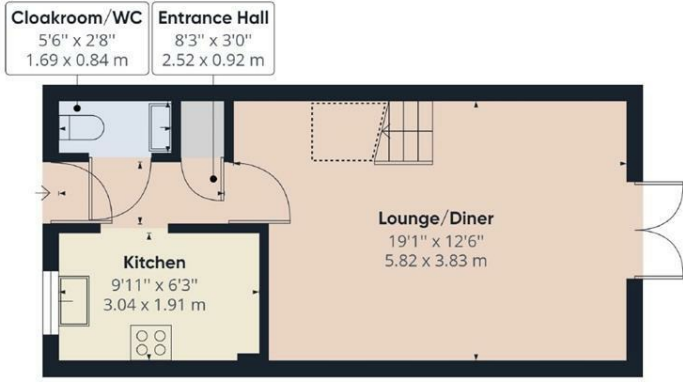

Ground Floor Building 1

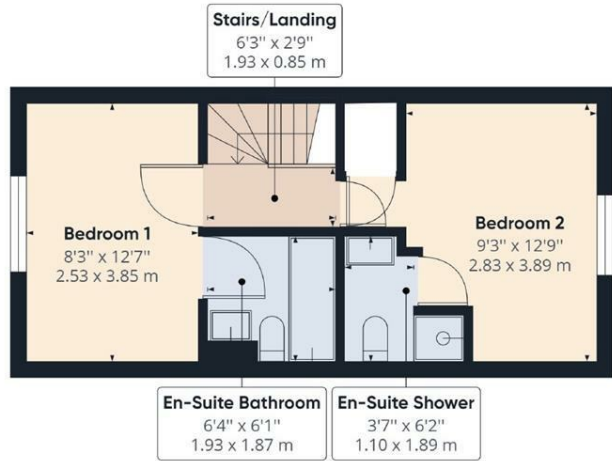

Floor 1 Building 1

Approximate total area<sup>(1)</sup>

651.14 ft<sup>2</sup>  
60.49 m<sup>2</sup>

Reduced headroom

16.05 ft<sup>2</sup>  
1.49 m<sup>2</sup>

(1) Excluding balconies and terraces

Reduced headroom (below 1.5m/4.92ft)

While every attempt has been made to ensure accuracy, all measurements are approximate, not to scale. This floor plan is for illustrative purposes only.

GIRAFFE360

